

Product Data Sheet

Actuator 01NJ32

01NJ32 is a small actuator with push/pull force up to 3500N. It features compact outline and low noise level that is mainly suitable for medical and furniture applications such as recliners, beds, etc., as well as various industrial applications with limited installation space.

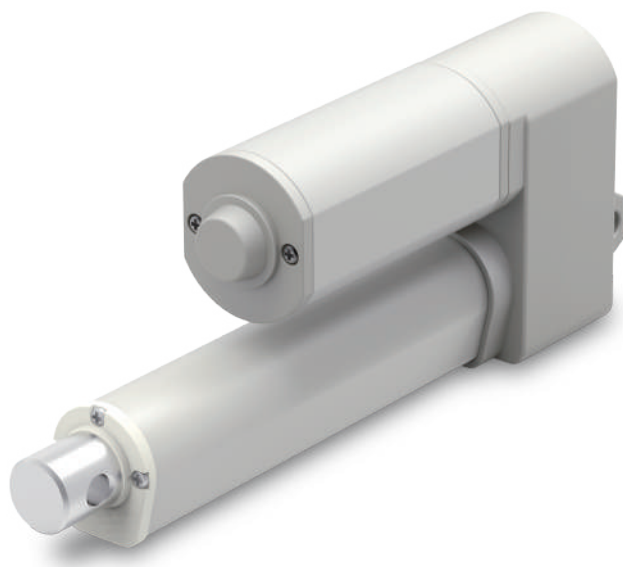

Features and Options

Main applications: Medical, furniture, industry

Standard features:

- Input voltage: 24V DC
- Max. load: 3500N (Push/Pull)
- Max. speed at no load: 26.0mm/sec (Typical value)
- Speed at full load: 5.0mm/sec (Typical value @3500N loaded)
- Stroke: 50 ~ 600mm
- Noise level: ≤ 52 dB
- IP level: IPX4, IP66 (Static; non-action)
- Aluminum alloy outer tube and gear box
- Color: Aluminum grey
- Preset limit switches
- Duty cycle: 10%, max. 2 min. continuous operation in 20 min.
- Operating ambient temperature: $-20^{\circ}\text{C} \sim +65^{\circ}\text{C}$
- Certified: CE Marking, Electromagnetic Compatibility Directive 2014/30/EU
(01NJ32-24NX motors only)

Options:

- Positioning signal feedback with dual Hall effect sensors
- Safety nut (in push direction)
- Mechanical push only extension tube

Performance Data

Model No.	Push / Pull Max. (N)	Typical Speed (mm/s) *		Typical Current @ 24V DC *	
		No Load	Full Load	No Load	Full Load
01NJ32-24N3-XXX.XXX-XXXXXXXX	3500	6.5	5.0	2.5	5.0
01NJ32-24N4-XXX.XXX-XXXXXXXX	3000	8.5	6.0	2.5	5.2
01NJ32-24N6-XXX.XXX-XXXXXXXX	2500	13.0	9.0	2.5	6.0
01NJ32-24N8-XXX.XXX-XXXXXXXX	2000	17.0	11.5	2.5	5.5
01NJ32-24NC-XXX.XXX-XXXXXXXX	1500	26.0	14.0	2.5	6.0
01NJ32-24P4-XXX.XXX-XXXXXXXX	3000	6.0	3.0	2.5	5.0
01NJ32-24P6-XXX.XXX-XXXXXXXX	2500	10.5	5.5	2.5	4.5
01NJ32-24P8-XXX.XXX-XXXXXXXX	2000	14.0	7.5	2.5	4.5

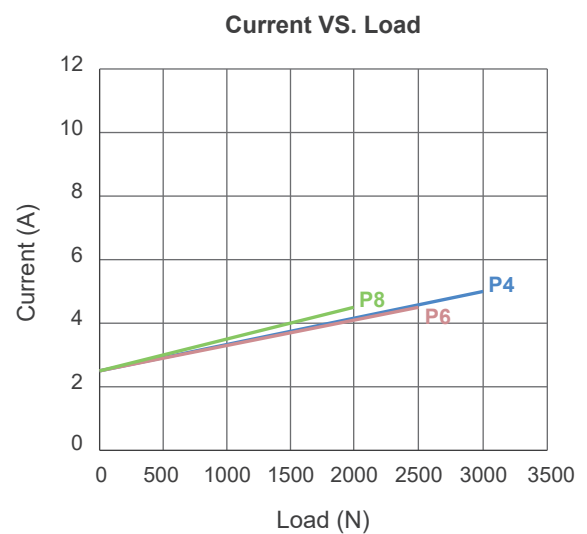
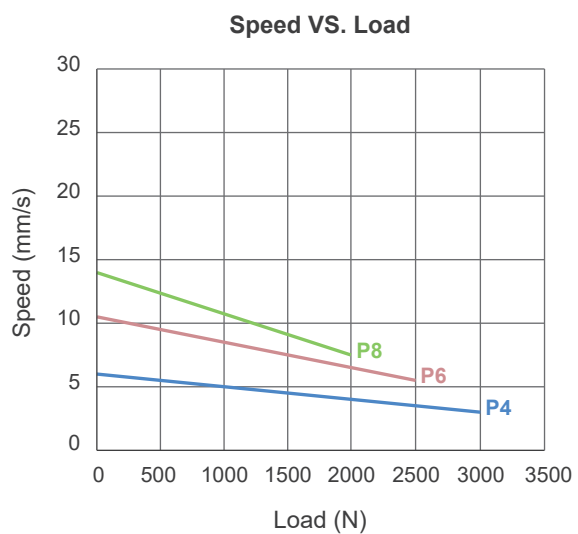
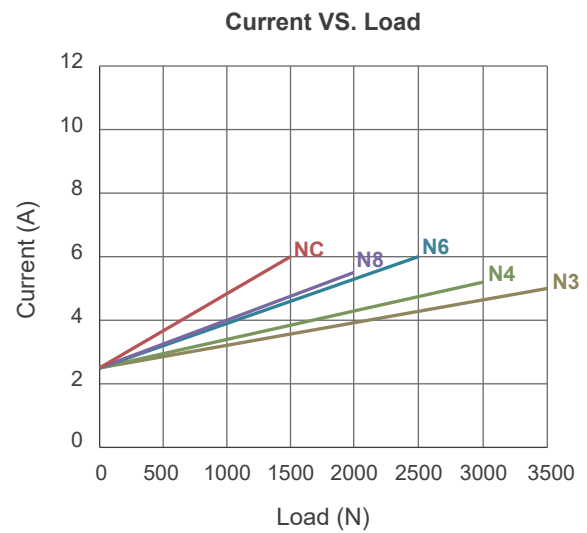
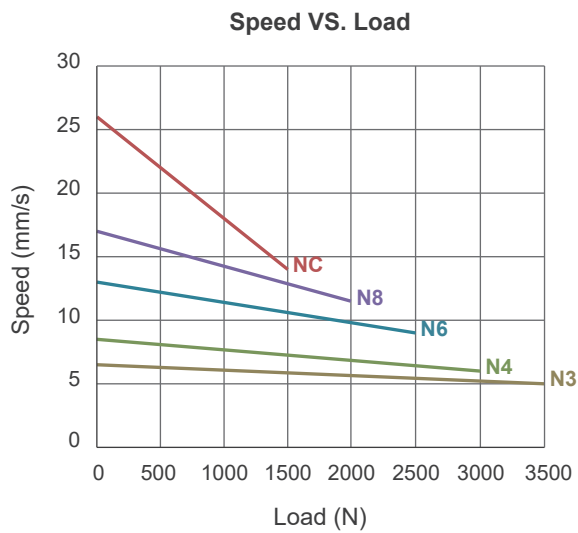

Remarks:

* The typical speed or typical current means the average value neither upper limit nor lower limit. The performance curves are made with typical values.

Dimensions

- Available stroke (S) range = 50 ~ 600mm (± 3 mm)
- Retracted length (A) $\cong S + 112\text{mm} + E + F + R + D$ (± 3 mm)

Stroke	E
$50 \leq S \leq 150\text{mm}$	0mm
$151 \leq S \leq 300\text{mm}$	10mm
$301 \leq S \leq 400\text{mm}$	20mm
$401 \leq S \leq 500\text{mm}$	30mm
$501 \leq S \leq 600\text{mm}$	40mm
Front connector code	F
1, 2	0mm
3	13mm
4	7mm
8	1mm
Rear connector code	R
0, 1	0mm
8	3mm
Safety option	D
0, P	0mm
S, A	10mm

- $S \geq 601\text{mm}$, please consult sales representative for feasibility and the available.
- Extended length (B) = Retracted length (A) + Stroke (S) (± 3 mm)

- Drawing
 - Basic (Without positioning feedback)

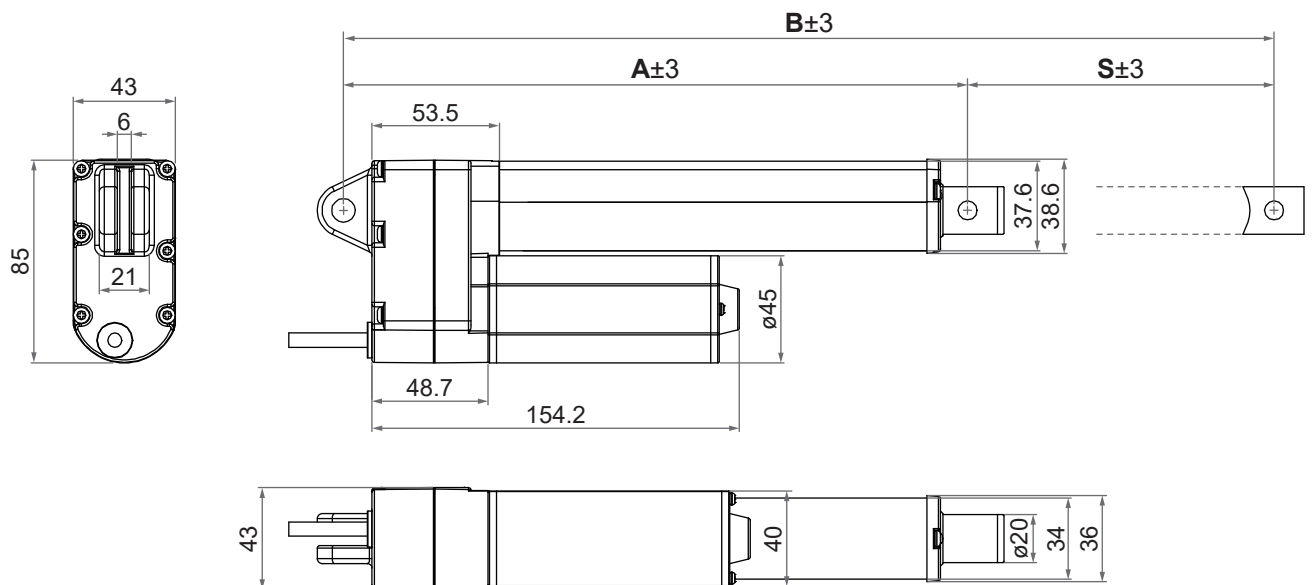

Unit: mm

- With dual Hall effect sensors for positioning

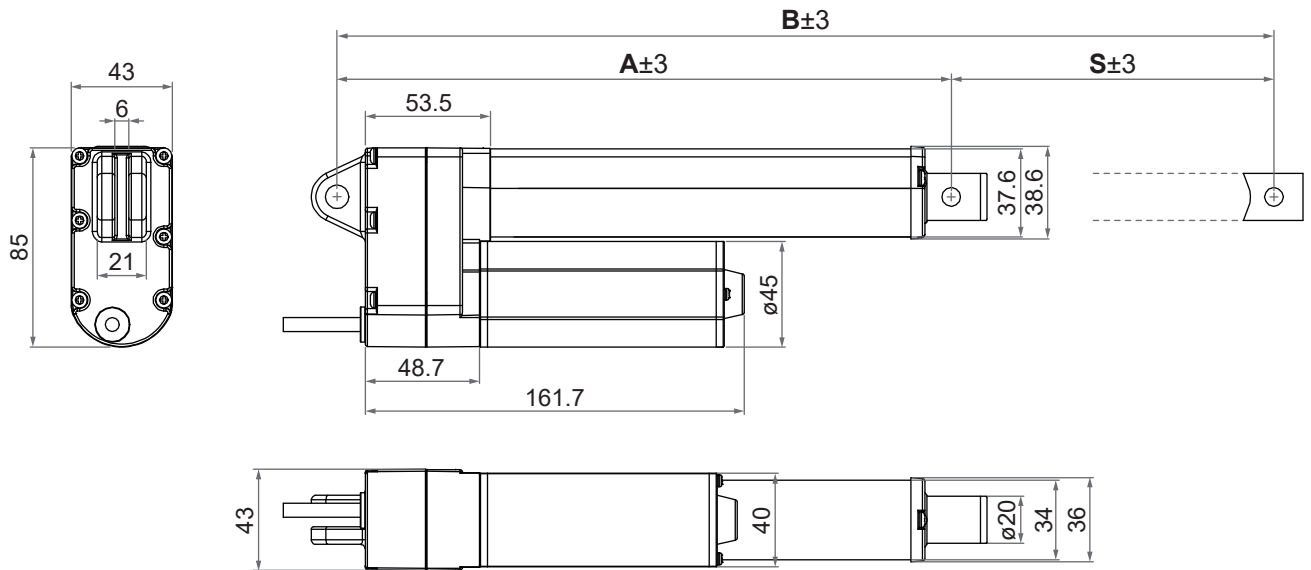

● Front connector

1: Metal solid

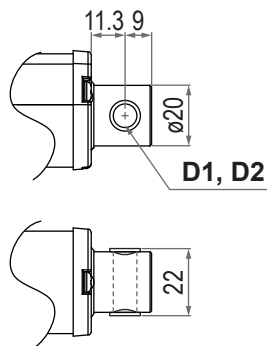

2: Drilled hole
(IP66 cannot be selected)

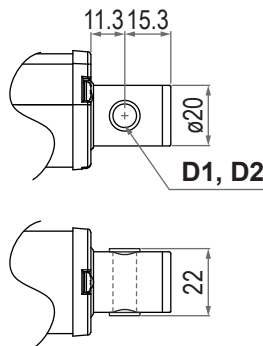

3: Metal slot

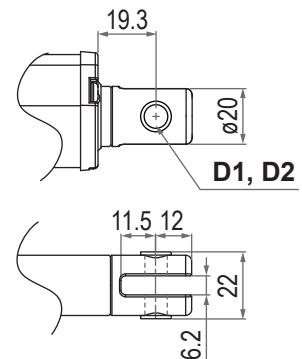

4: Plastic solid, black

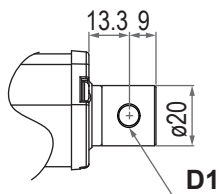

8: M6 screw

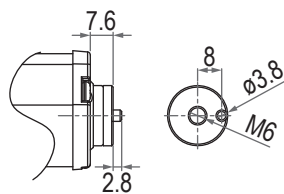

Front connector code	Diameter of pivot without bushing (D1)	Diameter of pivot with bushing (D2)
1	ø8, ø10	ø8
2	ø8, ø10	ø8
3	ø8, ø10	ø8
4	ø8, ø10	N/A
8	N/A	N/A

Unit: mm

• **Rear connector**

0: Metal slot

0°

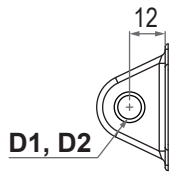

90°

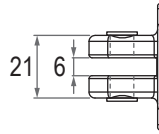

1: Metal solid

0°

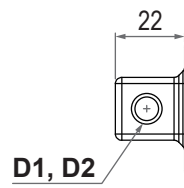

90°

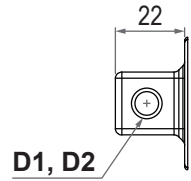
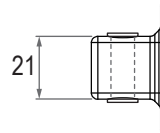
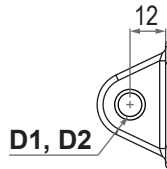
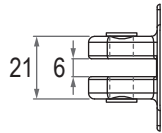
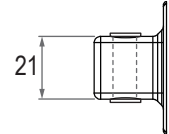

8: M6 screw

0°

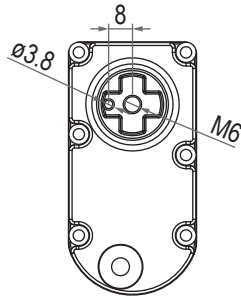
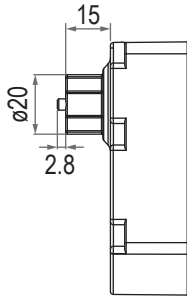

Rear connector code	Diameter of pivot without bushing (D1)	Diameter of pivot with bushing (D2)
0	ø8, ø10	ø8
1	ø8, ø10	ø8
8	N/A	N/A

Unit: mm

Compatibility

Product	Model	Application condition	01NJ32 spec
Control box	01XN45, 01NS6X, 01NS6X-M	• Max. 5A current per channel	• Without positioning feedback • With H-type or V-type DIN plug
	01XN23, 01NS6X-M	• Max. 5A current per channel	• With dual Hall effect sensors for positioning • With H-type or V-type DIN plug
	01XV50-M, 01XN41-M	• Max. 5A current per channel	• With LR-type minifit plug
Controller	01XU72		• Standard
Accessory	01NV22 mounting bracket (Fig. 1)	• Connect the front or rear connectors of the actuator	• Standard, mounting hole $\varnothing 8\text{mm}$ or $\varnothing 10\text{mm}$



Fig. 1

Remarks:

If the current limit of the selected control box is lower than the typical current of the actuator model under full load, the actuator could not be operated in full performance.

Cable Plug

H-type, V-type, LR-type or L3-type DIN plug

- Without positioning feedback

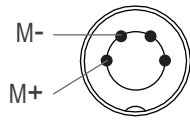

H-type or V-type
4-pin DIN plug

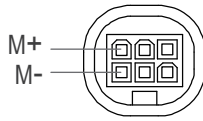

LR-type
6-pin minifit plug

- With dual Hall effect sensors for positioning

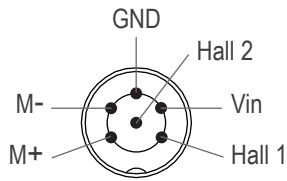

H-type or V-type
4-pin DIN plug

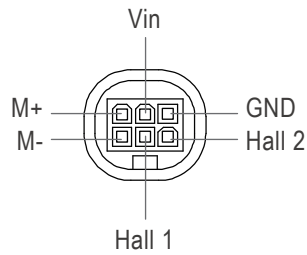

LR-type
6-pin minifit plug

Note:

Connect M+ to "Vdc +" & M- to "Vdc -" of DC power to extend the actuator.
Switch the polarity of DC input to retract it.



H-type plug



V-type plug



LR-type plug

Cable with Flying Leads

- Without positioning feedback

	Wire color	Definition	Descriptions
Power wires	Blue	DC power	Connect blue wire to "Vdc +" & brown wire to "Vdc -" of DC power to extend the actuator. Switch the polarity of DC input to retract it.
	Brown		

- With dual Hall effect sensors for positioning

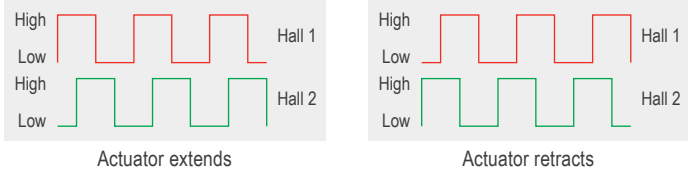
	Wire color	Definition	Descriptions																		
Power wires	Blue	DC power	Connect blue wire to "Vdc +" & brown wire to "Vdc -" of DC power to extend the actuator. Switch the polarity of DC input to retract it.																		
	Brown																				
Signal wires	Yellow	Vin	Voltage input range: 5 ~ 20V																		
	Red	Hall 1 output	High= Input - 1.2V ($\pm 0.6V$) Low= GND Hall signal data: 																		
	Green	Hall 2 output	Hall effect sensor resolution: <table border="1"> <thead> <tr> <th>Model No.</th> <th>Resolution (Pulses/mm)</th> </tr> </thead> <tbody> <tr> <td>01NJ32-24N3-XXX.XXX-XXXHXXX</td> <td>10.125</td> </tr> <tr> <td>01NJ32-24N4-XXX.XXX-XXXHXXX</td> <td>7.594</td> </tr> <tr> <td>01NJ32-24N6-XXX.XXX-XXXHXXX</td> <td>5.063</td> </tr> <tr> <td>01NJ32-24N8-XXX.XXX-XXXHXXX</td> <td>3.797</td> </tr> <tr> <td>01NJ32-24NC-XXX.XXX-XXXHXXX</td> <td>2.531</td> </tr> <tr> <td>01NJ32-24P4-XXX.XXX-XXXHXXX</td> <td>7.594</td> </tr> <tr> <td>01NJ32-24P6-XXX.XXX-XXXHXXX</td> <td>5.063</td> </tr> <tr> <td>01NJ32-24P8-XXX.XXX-XXXHXXX</td> <td>3.797</td> </tr> </tbody> </table>	Model No.	Resolution (Pulses/mm)	01NJ32-24N3-XXX.XXX-XXXHXXX	10.125	01NJ32-24N4-XXX.XXX-XXXHXXX	7.594	01NJ32-24N6-XXX.XXX-XXXHXXX	5.063	01NJ32-24N8-XXX.XXX-XXXHXXX	3.797	01NJ32-24NC-XXX.XXX-XXXHXXX	2.531	01NJ32-24P4-XXX.XXX-XXXHXXX	7.594	01NJ32-24P6-XXX.XXX-XXXHXXX	5.063	01NJ32-24P8-XXX.XXX-XXXHXXX	3.797
	Model No.	Resolution (Pulses/mm)																			
	01NJ32-24N3-XXX.XXX-XXXHXXX	10.125																			
01NJ32-24N4-XXX.XXX-XXXHXXX	7.594																				
01NJ32-24N6-XXX.XXX-XXXHXXX	5.063																				
01NJ32-24N8-XXX.XXX-XXXHXXX	3.797																				
01NJ32-24NC-XXX.XXX-XXXHXXX	2.531																				
01NJ32-24P4-XXX.XXX-XXXHXXX	7.594																				
01NJ32-24P6-XXX.XXX-XXXHXXX	5.063																				
01NJ32-24P8-XXX.XXX-XXXHXXX	3.797																				
Black	GND																				

Certifications

01NJ32 actuator is compliant with the following regulations, in terms of the essential conformity requirements of EMC Directive of 2014/30/EU.

Emission
EN 61000-6-3:2007+A1:2011+AC:2012
EN IEC 61000-6-1:2019

Ordering Key

	01NJ32- 24 N4 - 212 . 312 - 2 0 0 H 0 4 0
Input voltage	24: 24V DC
Motor and Spindle type	N3: 4500rpm / 3mm pitch N4: 4500rpm / 4mm pitch N6: 4500rpm / 6mm pitch N8: 4500rpm / 8mm pitch NC: 4500rpm / 12mm pitch P4: 3800rpm / 4mm pitch P6: 3800rpm / 6mm pitch P8: 3800rpm / 8mm pitch
Retracted length <i>(Refer to Page 3)</i>	XXX
Extended length <i>(Refer to Page 3)</i>	XXX
Front connector <i>(Refer to Page 4)</i>	1: Metal solid 2: Drilled hole 3: Metal slot 4: Plastic solid, black 8: M6 screw
Rear connector <i>(Refer to Page 5)</i>	1: Metal solid 0: Metal slot 8: M6 screw
Pivot orientation of rear connector <i>(Refer to Page 5)</i>	0: 0° 9: 90°
Positioning feedback	0: None H: Dual Hall effect sensors
Option	0: None S: Safety nut P: Push only A: Safety nut + Push only
IP level	0: No designation 4: IPX4 6: IP66
Cable length	0: 300mm straight 3: 1000mm straight A: 450mm with 300mm coiled